

# Heitmann und Bruun GmbH



## STIRNRÄDER

	Zahnbreite "B" mm	Gesamtbreite "A" mm
Modul 3	30	50,0
Modul 4	40	60,0
Modul 5	50	75,0
Modul 6	60	80,0

Werkstoff C 43

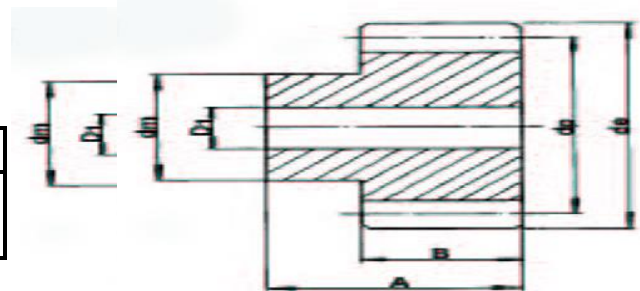

	Modul 3,0				Modul 4,0				Modul 5,0				Modul 6,0			
	de	dp	dm	D1	de	dp	dm	D1	de	dp	dm	D1	de	dp	dm	D1
12	42,0	36,0	25	12	56,0	48,0	35	14	70,0	60,0	45	16	84,0	72,0	54	
13	45,0	39,0	25	12	60,0	52,0	40	14	75,0	65,0	50	16	90,0	78,0	60	
14	48,0	42,0	30	12	64,0	56,0	45	14	80,0	70,0	55	20				
15	51,0	45,0	35	12	68,0	60,0	45	14	85,0	75,0	60	20	102,0	90,0	70	
16	54,0	48,0	38	15	72,0	64,0	50	15	90,0	80,0	65	20	108,0	96,0	75	
17	57,0	51,0	42	15	76,0	68,0	50	15	95,0	85,0	70	20				
18	60,0	54,0	45	15	80,0	72,0	50	15	100,0	90,0	70	20	120,0	108,0	80	
19	63,0	57,0	45	15	84,0	76,0	60	15	105,0	95,0	70	20				
20	66,0	60,0	45	15	88,0	80,0	60	15	110,0	100,0	80	20	132,0	120,0	90	
21	69,0	63,0	45	15	92,0	84,0	70	20	115,0	105,0	80	20				
22	72,0	66,0	50	15	96,0	88,0	70	20	120,0	110,0	80	25				
23	75,0	69,0	50	15	100,0	92,0	75	20	125,0	115,0	80	25				
24	78,0	72,0	50	16	104,0	96,0	75	20	130,0	120,0	90	25	156,0	144,0	110	
25	81,0	75,0	60	16	108,0	100,0	75	20	135,0	125,0	90	25	162,0	150,0	110	
26	84,0	78,0	60	16	112,0	104,0	75	20	140,0	130,0	##	25				
27	87,0	81,0	60	16	116,0	108,0	75	20	145,0	135,0	##	25				
28	90,0	84,0	60	16	120,0	112,0	75	20	150,0	140,0	##	25				
29	93,0	87,0	60	16	124,0	116,0	75	20	155,0	145,0	##	25				
30	96,0	90,0	60	16	128,0	120,0	75	20	160,0	150,0	##	25				
31	99,0	93,0	70	20	132,0	124,0	80	20								
32	102,0	96,0	70	20	136,0	128,0	80	20								
33	105,0	99,0	70	20	140,0	132,0	80	20								
34	108,0	102,0	70	20	144,0	136,0	80	20								
35	111,0	105,0	70	20	148,0	140,0	80	20								
36	114,0	108,0	70	20	152,0	144,0	80	20								
37	117,0	111,0	80	20												
38	120,0	114,0	80	20												
39	123,0	117,0	80	20												
40	126,0	120,0	80	20												
41	129,0	123,0	90	20												
42	132,0	126,0	90	20												
43	135,0	129,0	90	20												
44	138,0	132,0	90	20												
45	141,0	135,0	90	20												
46	144,0	138,0	90	20												
47	147,0	141,0	90	20												
48	150,0	144,0	##	20												
49																
50																
51																
52																
53																
54																
55																
56																
57																
58																
59																
60																
61																
62																
63																
64																
65																
66																
67																
68																
69																
70																

alle Angaben ohne Gewähr